

SOUTHERN CALIFORNIA ALASKAN MALAMUTE CLUB, Inc.
 (Licensed by the American Kennel Club)
36th ANNUAL INDEPENDENT SPECIALTY SHOW AND SWEEPSTAKES



Los Angeles County Fairplex
1101 West McKinley Avenue, Pomona, California 91768
Friday March 2, 2018

INDOORS – Unbenched - SHOW HOURS: 8:00 a.m. to 9:00 p.m.

DAY OF SHOW PARKING

Parking is payable to Fairplex upon arrival. Do not mail ahead of time. Gates open 6:00 AM. Parking is \$14.00; motor homes will cost more.

DIRECTIONS - Take Fairplex Drive offramp from either direction off of I-10 San Bernardino Freeway.

Drive North to McKinley Ave., left to gate 17.

EMERGENCY VETERINARY HOSPITAL – Central Veterinary Hospital
 281 N. Central Avenue, Upland, CA 91786 (909) 981-2855, Open 24 hours
 Take Arrow Hwy or the 10 Fwy east to Central. Left on Central.

TRANSFERS - The Deadline for Exhibitors wishing to transfer their dogs is at the Superintendent's Table 30 minutes prior to the start of any regular judging.

Superintendents

Jack Bradshaw Dog Show Superintendents/Est. 1898
Post Office Box 227303, Los Angeles, California 90022

Telephone: (323) 727-0136; FAX: (323) 727-2949; WEB: www.jbradshaw.com

Marion Bradshaw / Barbara Bradshaw / Susan Bradshaw MacLyman
Julie Bradshaw Draper / John Bradshaw / Eloise O'Donnell/Cindy Marshall/Keith MacLyman

One or more of the above superintendents will attend the show

Total Dogs in Show: 20 Total Dog Entries in Show: 29

Ring No 15 -- Judge: **Mrs. Sylvia Thomas**, 2155 Hackamore Place, Riverside, CA 92506
 Ring Steward: Stephen Starks

10:00 AM --8 Alaskan Malamutes Sweepstakes 5-3

1 Alaskan Malamute Veteran Sweepstakes 1-0 Total 9

Ring No 15 -- Judge: **Mrs. Judith V. Daniels**, 8015 Litchfield Ln, Spring, TX 77379

10:30 AM-- 19 Alaskan Malamute 6-4-(5-3)-1 PV Total 19

Reminder: Raffle to be held ringside following Breed judging

Fairplex Hall 6

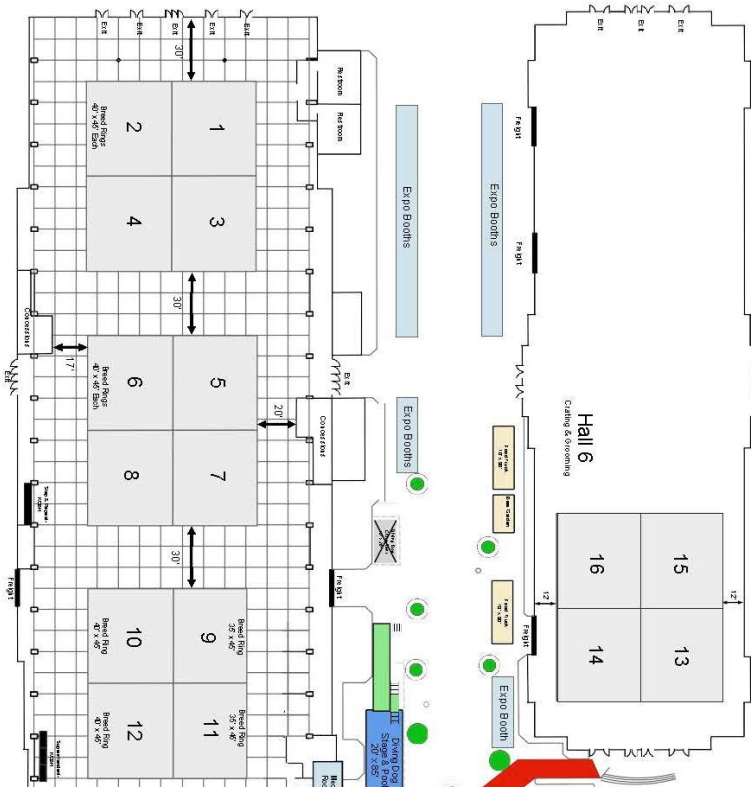

Fairplex Hall 4

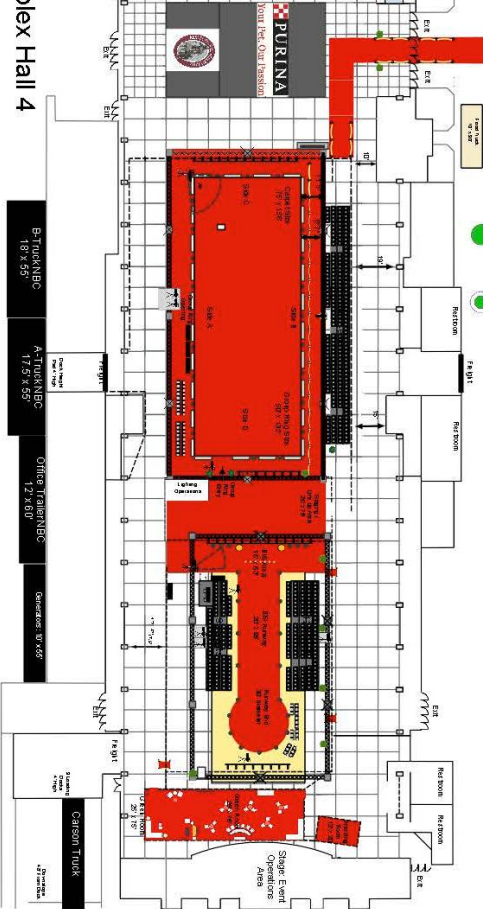

EXHIBITOR
 1101 W. Kendall Avenue
 Pomona, CA 91768
 Beverly Hills Dog Show

Map Legend

- Red Carpet Area
- Blue Carpet Area
- Single Carpet Booth
- Shelving Booth 7' x 7'
- Orange Line: Free & Dogs on the floor
- Trust Towel
- Seating: Blue dog modular seats, each row 6' elevation gain
- Television Camera Placement
- Boquet Table 8' x 30"
- Feeding Chair

Discor Elements
 All components are ON THE FLOOR

- Power (yellow)
- Signal (light blue)
- Power Management (red)
- Restroom (light blue)
- Concessions (light blue)

Scale: 1" = 4' 0"